

Tabulated Gravity Data From  
 Talkeetna (A-1), (B-1); Talkeetna Mtns. (A-6), (B-6);  
 Tyonek (D-1), and Anchorage (D-8) quadrangles.

STATION	DATE	TIME	INSTRUMENT	READ	TEMP.	BAROM.	REDUCED GRAVITY
TLK A1	1968	10:15	GG-1	98.5	10.0	30.0	978.5
TLK A2	1968	10:20	GG-1	98.5	10.0	30.0	978.5
TLK A3	1968	10:25	GG-1	98.5	10.0	30.0	978.5
TLK A4	1968	10:30	GG-1	98.5	10.0	30.0	978.5
TLK A5	1968	10:35	GG-1	98.5	10.0	30.0	978.5
TLK A6	1968	10:40	GG-1	98.5	10.0	30.0	978.5
TLK B1	1968	10:45	GG-1	98.5	10.0	30.0	978.5
TLK B2	1968	10:50	GG-1	98.5	10.0	30.0	978.5
TLK B3	1968	10:55	GG-1	98.5	10.0	30.0	978.5
TLK B4	1968	11:00	GG-1	98.5	10.0	30.0	978.5
TLK B5	1968	11:05	GG-1	98.5	10.0	30.0	978.5
TLK B6	1968	11:10	GG-1	98.5	10.0	30.0	978.5
TLK B7	1968	11:15	GG-1	98.5	10.0	30.0	978.5
TLK B8	1968	11:20	GG-1	98.5	10.0	30.0	978.5
TLK B9	1968	11:25	GG-1	98.5	10.0	30.0	978.5
TLK B10	1968	11:30	GG-1	98.5	10.0	30.0	978.5
TLK B11	1968	11:35	GG-1	98.5	10.0	30.0	978.5
TLK B12	1968	11:40	GG-1	98.5	10.0	30.0	978.5
TLK B13	1968	11:45	GG-1	98.5	10.0	30.0	978.5
TLK B14	1968	11:50	GG-1	98.5	10.0	30.0	978.5
TLK B15	1968	11:55	GG-1	98.5	10.0	30.0	978.5
TLK B16	1968	12:00	GG-1	98.5	10.0	30.0	978.5
TLK B17	1968	12:05	GG-1	98.5	10.0	30.0	978.5
TLK B18	1968	12:10	GG-1	98.5	10.0	30.0	978.5
TLK B19	1968	12:15	GG-1	98.5	10.0	30.0	978.5
TLK B20	1968	12:20	GG-1	98.5	10.0	30.0	978.5
TLK B21	1968	12:25	GG-1	98.5	10.0	30.0	978.5
TLK B22	1968	12:30	GG-1	98.5	10.0	30.0	978.5
TLK B23	1968	12:35	GG-1	98.5	10.0	30.0	978.5
TLK B24	1968	12:40	GG-1	98.5	10.0	30.0	978.5
TLK B25	1968	12:45	GG-1	98.5	10.0	30.0	978.5
TLK B26	1968	12:50	GG-1	98.5	10.0	30.0	978.5
TLK B27	1968	12:55	GG-1	98.5	10.0	30.0	978.5
TLK B28	1968	13:00	GG-1	98.5	10.0	30.0	978.5
TLK B29	1968	13:05	GG-1	98.5	10.0	30.0	978.5
TLK B30	1968	13:10	GG-1	98.5	10.0	30.0	978.5
TLK B31	1968	13:15	GG-1	98.5	10.0	30.0	978.5
TLK B32	1968	13:20	GG-1	98.5	10.0	30.0	978.5
TLK B33	1968	13:25	GG-1	98.5	10.0	30.0	978.5
TLK B34	1968	13:30	GG-1	98.5	10.0	30.0	978.5
TLK B35	1968	13:35	GG-1	98.5	10.0	30.0	978.5
TLK B36	1968	13:40	GG-1	98.5	10.0	30.0	978.5
TLK B37	1968	13:45	GG-1	98.5	10.0	30.0	978.5
TLK B38	1968	13:50	GG-1	98.5	10.0	30.0	978.5
TLK B39	1968	13:55	GG-1	98.5	10.0	30.0	978.5
TLK B40	1968	14:00	GG-1	98.5	10.0	30.0	978.5
TLK B41	1968	14:05	GG-1	98.5	10.0	30.0	978.5
TLK B42	1968	14:10	GG-1	98.5	10.0	30.0	978.5
TLK B43	1968	14:15	GG-1	98.5	10.0	30.0	978.5
TLK B44	1968	14:20	GG-1	98.5	10.0	30.0	978.5
TLK B45	1968	14:25	GG-1	98.5	10.0	30.0	978.5
TLK B46	1968	14:30	GG-1	98.5	10.0	30.0	978.5
TLK B47	1968	14:35	GG-1	98.5	10.0	30.0	978.5
TLK B48	1968	14:40	GG-1	98.5	10.0	30.0	978.5
TLK B49	1968	14:45	GG-1	98.5	10.0	30.0	978.5
TLK B50	1968	14:50	GG-1	98.5	10.0	30.0	978.5
TLK B51	1968	14:55	GG-1	98.5	10.0	30.0	978.5
TLK B52	1968	15:00	GG-1	98.5	10.0	30.0	978.5
TLK B53	1968	15:05	GG-1	98.5	10.0	30.0	978.5
TLK B54	1968	15:10	GG-1	98.5	10.0	30.0	978.5
TLK B55	1968	15:15	GG-1	98.5	10.0	30.0	978.5
TLK B56	1968	15:20	GG-1	98.5	10.0	30.0	978.5
TLK B57	1968	15:25	GG-1	98.5	10.0	30.0	978.5
TLK B58	1968	15:30	GG-1	98.5	10.0	30.0	978.5
TLK B59	1968	15:35	GG-1	98.5	10.0	30.0	978.5
TLK B60	1968	15:40	GG-1	98.5	10.0	30.0	978.5
TLK B61	1968	15:45	GG-1	98.5	10.0	30.0	978.5
TLK B62	1968	15:50	GG-1	98.5	10.0	30.0	978.5
TLK B63	1968	15:55	GG-1	98.5	10.0	30.0	978.5
TLK B64	1968	16:00	GG-1	98.5	10.0	30.0	978.5
TLK B65	1968	16:05	GG-1	98.5	10.0	30.0	978.5
TLK B66	1968	16:10	GG-1	98.5	10.0	30.0	978.5
TLK B67	1968	16:15	GG-1	98.5	10.0	30.0	978.5
TLK B68	1968	16:20	GG-1	98.5	10.0	30.0	978.5
TLK B69	1968	16:25	GG-1	98.5	10.0	30.0	978.5
TLK B70	1968	16:30	GG-1	98.5	10.0	30.0	978.5
TLK B71	1968	16:35	GG-1	98.5	10.0	30.0	978.5
TLK B72	1968	16:40	GG-1	98.5	10.0	30.0	978.5
TLK B73	1968	16:45	GG-1	98.5	10.0	30.0	978.5
TLK B74	1968	16:50	GG-1	98.5	10.0	30.0	978.5
TLK B75	1968	16:55	GG-1	98.5	10.0	30.0	978.5
TLK B76	1968	17:00	GG-1	98.5	10.0	30.0	978.5
TLK B77	1968	17:05	GG-1	98.5	10.0	30.0	978.5
TLK B78	1968	17:10	GG-1	98.5	10.0	30.0	978.5
TLK B79	1968	17:15	GG-1	98.5	10.0	30.0	978.5
TLK B80	1968	17:20	GG-1	98.5	10.0	30.0	978.5
TLK B81	1968	17:25	GG-1	98.5	10.0	30.0	978.5
TLK B82	1968	17:30	GG-1	98.5	10.0	30.0	978.5
TLK B83	1968	17:35	GG-1	98.5	10.0	30.0	978.5
TLK B84	1968	17:40	GG-1	98.5	10.0	30.0	978.5
TLK B85	1968	17:45	GG-1	98.5	10.0	30.0	978.5
TLK B86	1968	17:50	GG-1	98.5	10.0	30.0	978.5
TLK B87	1968	17:55	GG-1	98.5	10.0	30.0	978.5
TLK B88	1968	18:00	GG-1	98.5	10.0	30.0	978.5
TLK B89	1968	18:05	GG-1	98.5	10.0	30.0	978.5
TLK B90	1968	18:10	GG-1	98.5	10.0	30.0	978.5
TLK B91	1968	18:15	GG-1	98.5	10.0	30.0	978.5
TLK B92	1968	18:20	GG-1	98.5	10.0	30.0	978.5
TLK B93	1968	18:25	GG-1	98.5	10.0	30.0	978.5
TLK B94	1968	18:30	GG-1	98.5	10.0	30.0	978.5
TLK B95	1968	18:35	GG-1	98.5	10.0	30.0	978.5
TLK B96	1968	18:40	GG-1	98.5	10.0	30.0	978.5
TLK B97	1968	18:45	GG-1	98.5	10.0	30.0	978.5
TLK B98	1968	18:50	GG-1	98.5	10.0	30.0	978.5
TLK B99	1968	18:55	GG-1	98.5	10.0	30.0	978.5
TLK B100	1968	19:00	GG-1	98.5	10.0	30.0	978.5

**EXPLANATION**

GRAVITY ANOMALY CONTOURS  
 Contour interval equals five milligals  
 Approximate location

Area of low gravity

GRAVITY STATION DATA FROM:  
 Alaska DGS, Hockett, 1976  
 USGS, Barnes et al., 1950-75

A density of 2.67 g/cm<sup>3</sup> was assumed in reducing the data to the simple Bouguer anomaly values. All data reduced with 1967 International Gravity Formula (International Ellipsoid) updated to the datum of 1958 1971 and referenced to the TLKR base station: Latitude 62° 19.40' N., Longitude 150° 6.45' W., Obs. Grav. = 98200.52 calculated by Barnes (1968, 1975).

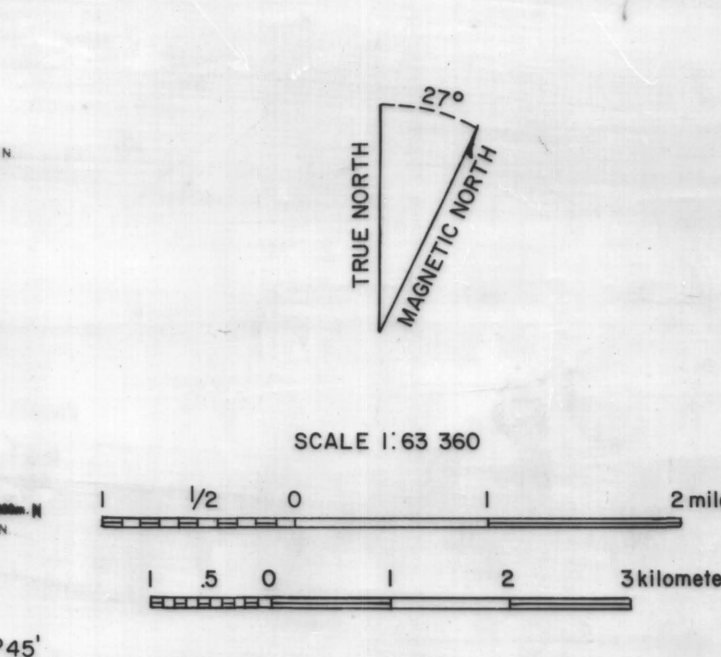
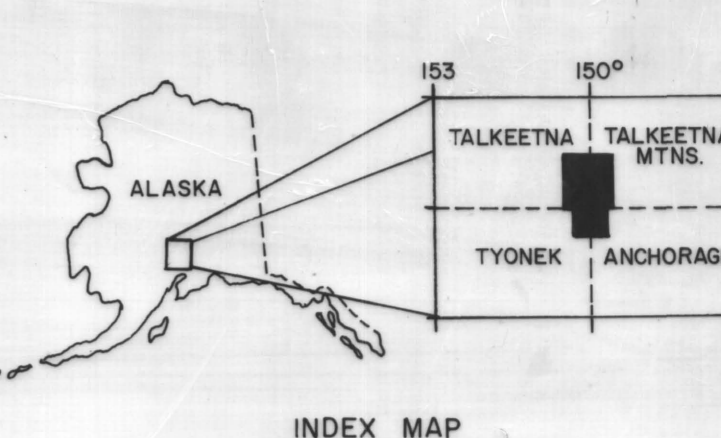
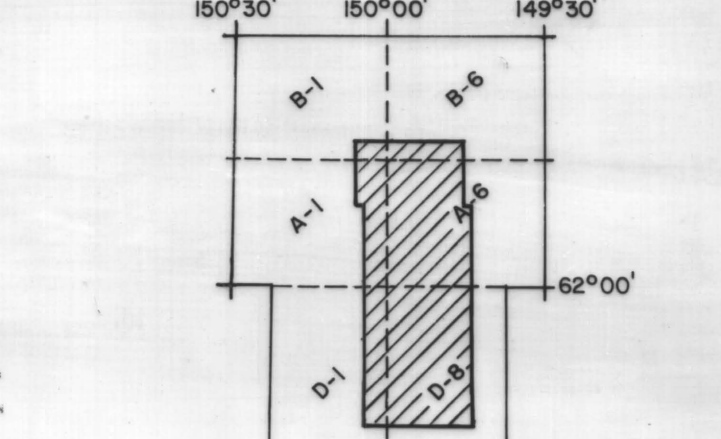

Prepared in cooperation with U.S. Geological Survey, Branch of Alaska Geology, Menlo Park, California.

\*This map is preliminary and has not been edited or reviewed for conformity with the Alaska Division of Geological and Geophysical Surveys standards.

**SIMPLE BOUGUER GRAVITY MAP  
 TALKEETNA - KASHWITNA RIVER AREA, ALASKA  
 BY STEVE W. HACKETT - 1978**