

ALSO REFER TO
KENAI PENINSULA
S CENTRAL MAP
1980
FOR ROAD SYSTEM

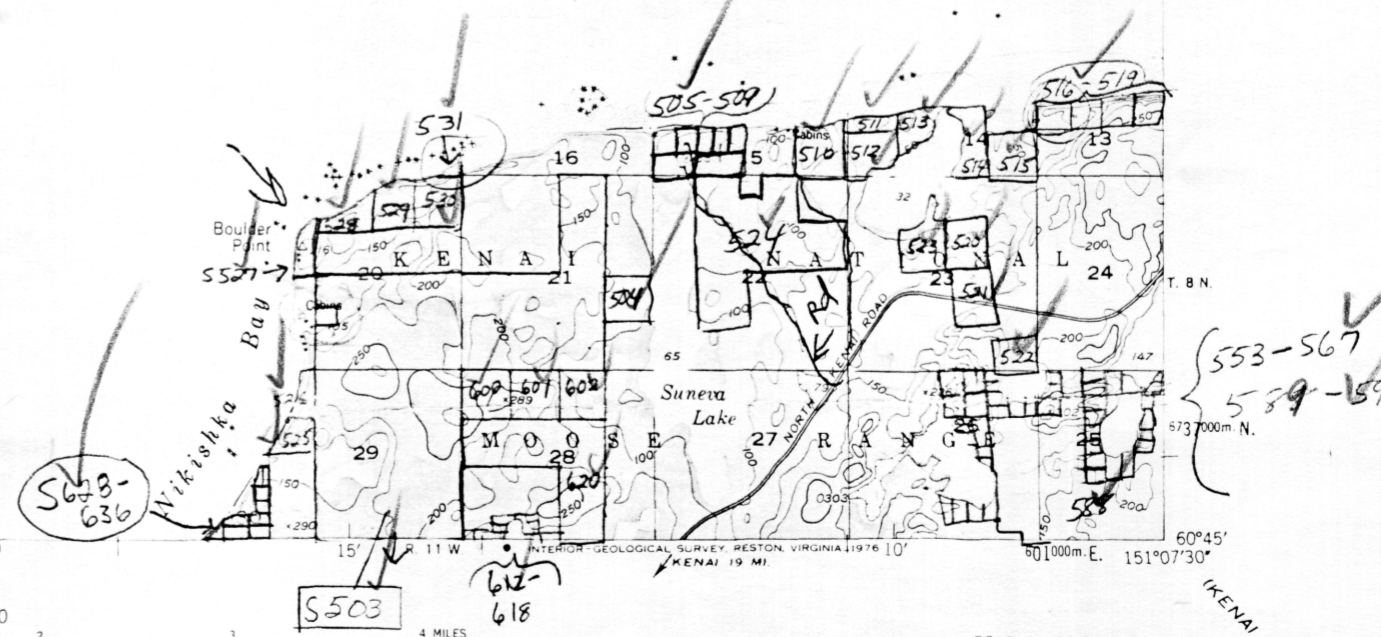

Mapped, edited, and published by the Geological Survey
Control by NOS/NOAA and USCE

Selected hydrographic data compiled from USC&GS
Charts H3196A (1910), H3210A (1910), and
8553 (1:194,154 scale) (1952). This information is not
intended for navigational purposes

Topography by photogrammetric methods from aerial photographs
taken 1950. Map not field checked

Universal Transverse Mercator projection, 1927 North American datum
10,000-foot grid based on Alaska coordinate system, zone 4
1000 metre Universal Transverse Mercator grid ticks,
zone 5, shown in blue

Swamps, as portrayed, indicate only the wetter areas,
usually of low relief, as interpreted from aerial photographs

Lake elevations are unchecked

SCALE 1:63 600

CONTOUR INTERVAL 50 FEET
NATIONAL GEODETIC VERTICAL DATUM OF 1929
DEPTH CURVES AND SOUNDINGS IN FEET—D.M. IS MEAN LOWER LOW WATER
SHORELINE SHOWN REPRESENTS THE APPROXIMATE LINE OF MEAN HIGH WATER
THE AVERAGE RANGE OF TIDE IS APPROXIMATELY 18 FEET

FOR SALE BY U. S. GEOLOGICAL SURVEY
FAIRBANKS, ALASKA 99701, DENVER, COLORADO 80225, OR RESTON, VIRGINIA 22092
A FOLDER DESCRIBING TOPOGRAPHIC MAPS AND SYMBOLS IS AVAILABLE ON REQUEST

ROAD CLASSIFICATION
Light duty

QUADRANGLE LOCATION

KENAI (D-4), ALASKA
N6045-W15107 5/15"

1950
MINOR REVISIONS 1974