

UNITED STATES  
 DEPARTMENT OF THE INTERIOR  
 GEOLOGICAL SURVEY

ANCHORAGE (D-5) QUADRANGLE  
 ALASKA - MATANUSKA - SUSITNA BOROUGH  
 1:63 360 SERIES (TOPOGRAPHIC)

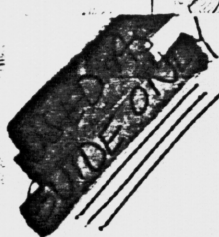
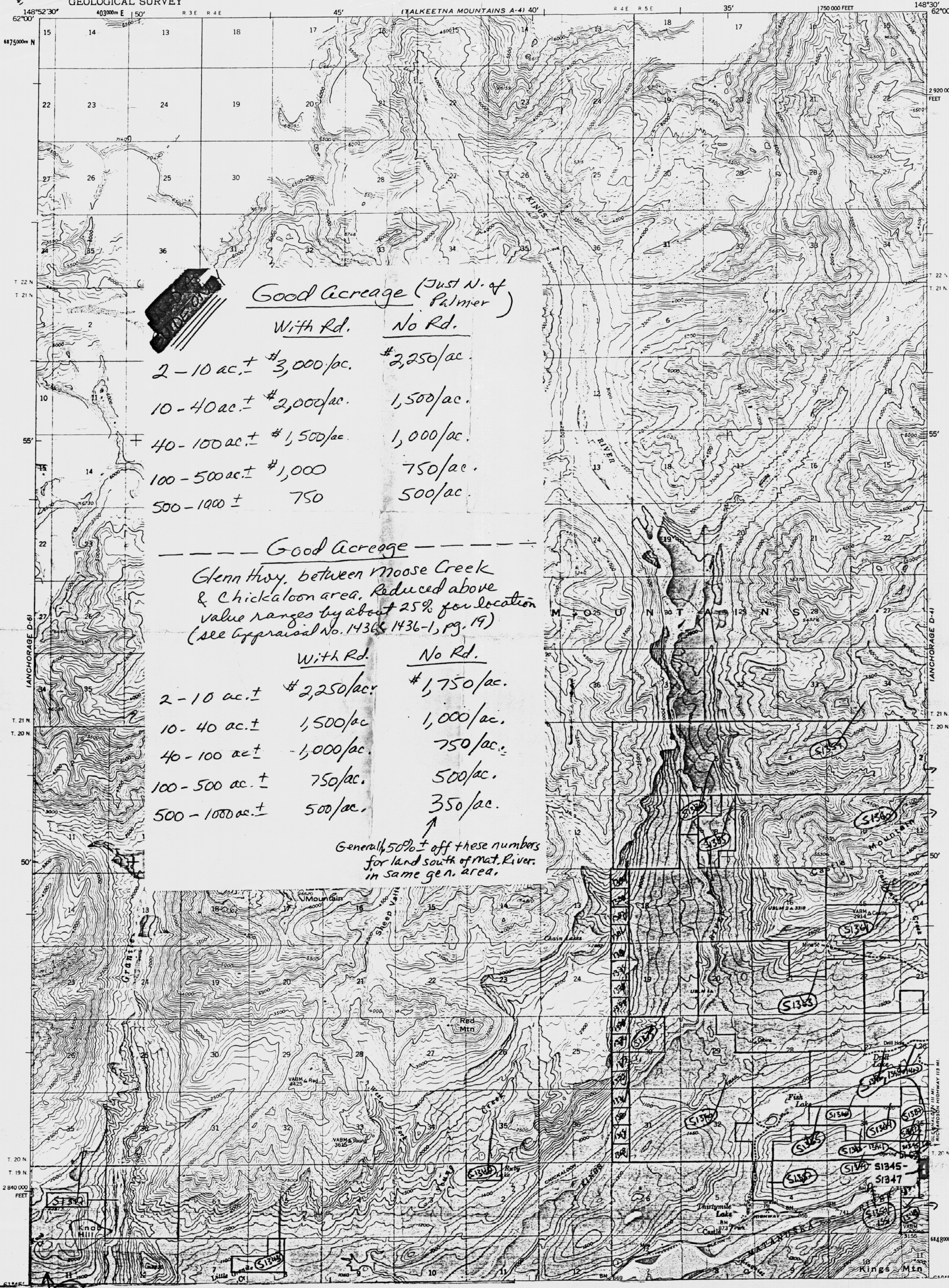

Good Acreage (Just N. of Palmer)

|                 | <u>With Rd.</u> | <u>No Rd.</u> |
|-----------------|-----------------|---------------|
| 2 - 10 ac. ±    | \$3,000/ac.     | \$2,250/ac.   |
| 10 - 40 ac. ±   | \$2,000/ac.     | 1,500/ac.     |
| 40 - 100 ac. ±  | \$1,500/ac.     | 1,000/ac.     |
| 100 - 500 ac. ± | \$1,000         | 750/ac.       |
| 500 - 1000 ±    | 750             | 500/ac.       |

Good Acreage

Glenn Hwy. between Moose Creek & Chickaloon area. Reduced above value ranges by about 25% for location (see Appraisal No. 1436 & 1436-1, pg. 19)

|                  | <u>With Rd.</u> | <u>No Rd.</u> |
|------------------|-----------------|---------------|
| 2 - 10 ac. ±     | \$2,250/ac.     | \$1,750/ac.   |
| 10 - 40 ac. ±    | 1,500/ac.       | 1,000/ac.     |
| 40 - 100 ac. ±   | 1,000/ac.       | 750/ac.       |
| 100 - 500 ac. ±  | 750/ac.         | 500/ac.       |
| 500 - 1000 ac. ± | 500/ac.         | 350/ac.       |

↑  
 Generally 50% ± off these numbers for land south of Mat. River. in same gen. area.

17.