

UNITED STATES
DEPARTMENT OF THE INTERIOR
GEOLOGICAL SURVEY

JUNEAU (B-6) QUADRANGLE
ALASKA
1:63 360 SERIES (TOPOGRAPHIC)

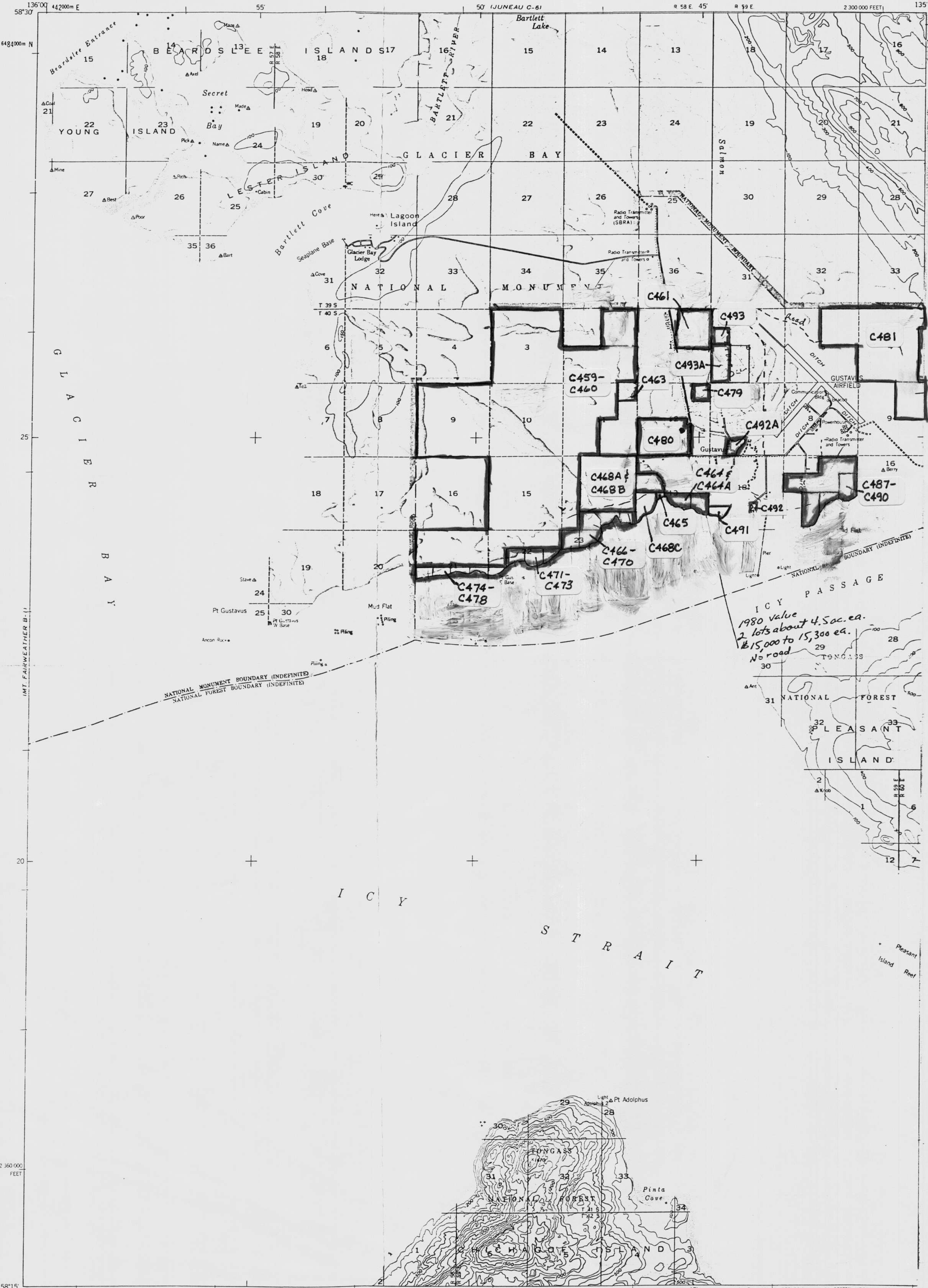

Mapped, edited, and published by the Geological Survey
Control by USGS and USC&GS
Topography by photogrammetric methods from aerial photographs taken 1948. Map not field checked
Selected hydrographic data compiled from USC&GS Charts 8202 (1:209 978 scale), 8304, and 8306 (1:160 000 scale). This information is not intended for navigational purposes
Universal Transverse Mercator projection, 1927 North American datum 10,000-foot grid based on Alaska coordinate system, zone 1 1000-meter Universal Transverse Mercator grid ticks, zone 8, shown in blue
Gray land lines represent unsurveyed and unmarked locations

SCALE 1:63360
4 MILES
5 KILOMETERS

ROAD CLASSIFICATION
Medium-duty ——— Light-duty ———
Unimproved dirt - - - - -

CONTOUR INTERVAL 100 FEET
NATIONAL GEODETIC VERTICAL DATUM OF 1929
DEPTH CURVES IN FEET - DATUM IS MEAN LOWER LOW WATER
SHORELINE SHOWN REPRESENTS THE APPROXIMATE LINE OF MEAN HIGH WATER
THE AVERAGE RANGE OF TIDE IS APPROXIMATELY 12 FEET

FOR SALE BY U.S. GEOLOGICAL SURVEY
92701 DENVER, COLORADO 80202 OR RESTON, VIRGINIA 22092

JUNEAU (B-6), ALASKA
N5815-W13540/15X20
1948