

FINAL

UNITED STATES  
DEPARTMENT OF THE INTERIOR  
GEOLOGICAL SURVEY

TALKEETNA (A-1) QUADRANGLE  
ALASKA  
1:63,360 SERIES (TOPOGRAPHIC)

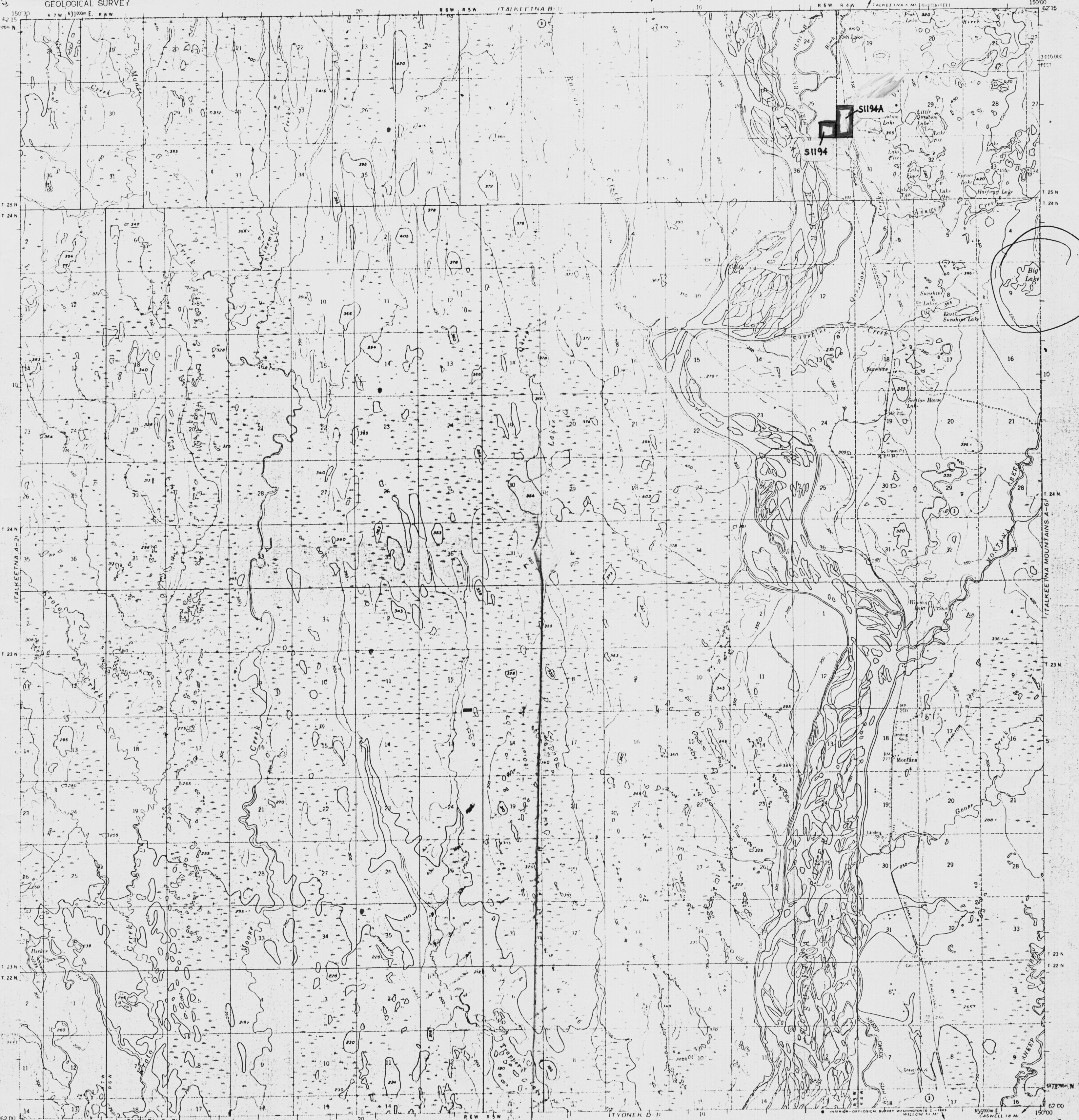

Map made by the Geological Survey  
Control by USGS and USACGS.  
Topography by photogrammetric methods from aerial photographs  
taken 1951 and 1952; field annotated 1958. Map not field checked.  
Universal Transverse Mercator projection, 1927 North American datum.  
10,000-foot grid based on Alaska coordinate system, zone 4.  
100-foot minor Universal Transverse Mercator grid ticks.  
Zones 5 shown in blue.  
Gray land lines represent unsurveyed and unmarked locations.

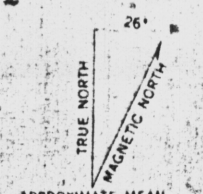

SCALE 1:63,360

ROAD CLASSIFICATION  
Light-duty      Unimproved dirt  
State Route



TALKEETNA (A-1), ALASKA  
NAD 83 - UTM 1000 / 15X30