

UNITED STATES
DEPARTMENT OF THE INTERIOR
GEOLOGICAL SURVEY

TYONEK (B-1) QUADRANGLE
ALASKA
1:63 360 SERIES (TOPOGRAPHIC)

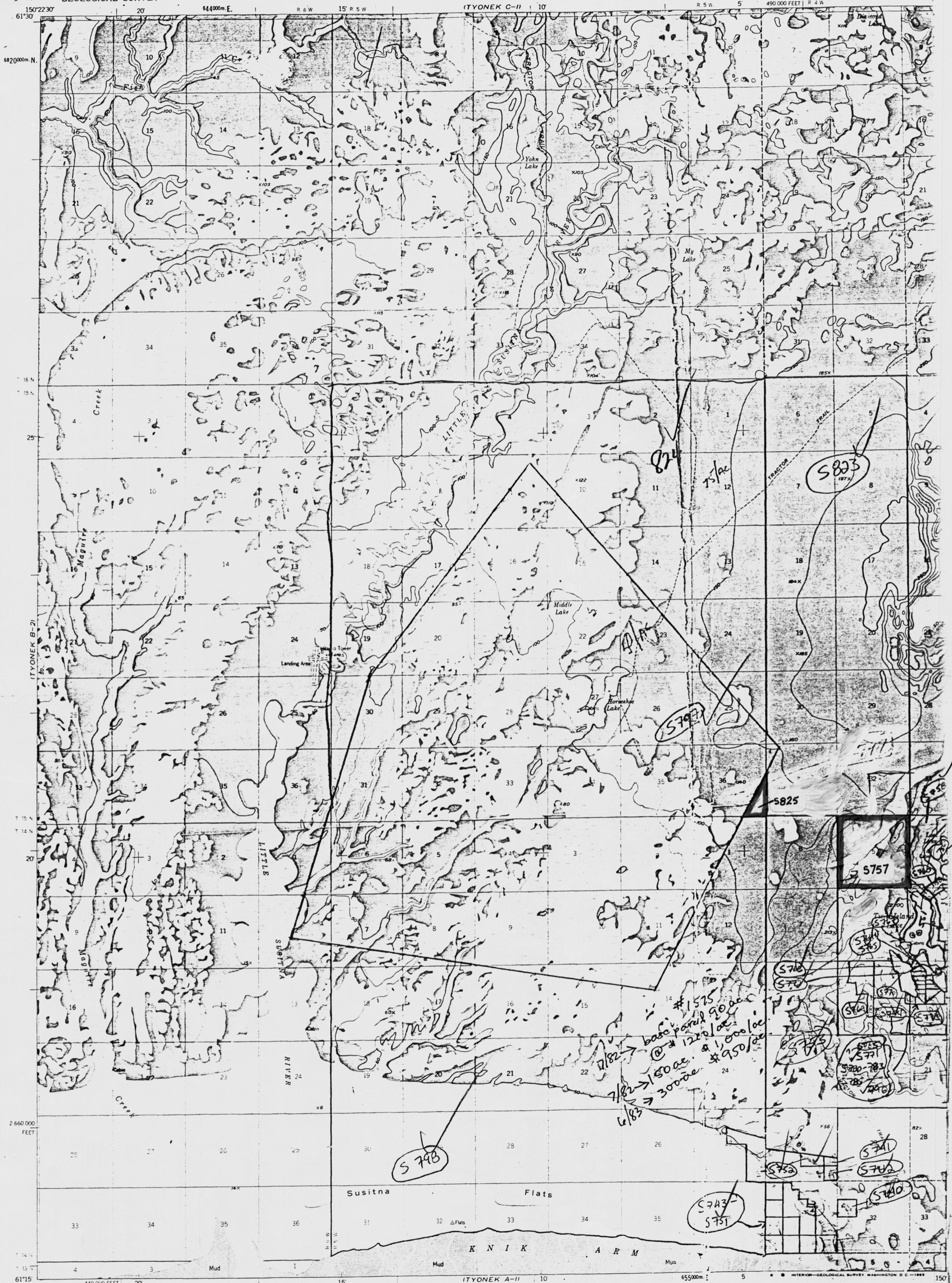

Mapped, edited, and published by the Geological Survey
Control by USGS and USC&GS

Topography by photogrammetric methods from aerial photographs
taken 1951, field annotated 1958. Map not field checked.

Selected hydrographic data compiled from aerial photographs.
This information is not intended for navigational purposes.

Universal Transverse Mercator projection, 1927 North American datum
10,000-foot grid based on Alaska coordinate system, zone 4
1000-meter Universal Transverse Mercator grid ticks,
zone 5, shown in blue.

Gray land lines represent unsurveyed and unmarked locations
predetermined by the Bureau of Land Management
Folio S 13, Seward Meridian

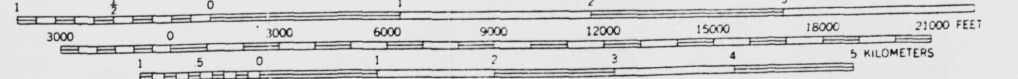
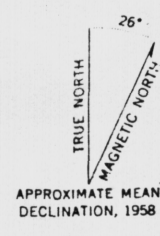

CONTOUR INTERVAL 50 FEET
DATUM IS MEAN SEA LEVEL
SHORELINE SHOWN REPRESENTS THE APPROXIMATE LINE OF MEAN HIGH WATER
THE MEAN RANGE OF TIDE IS APPROXIMATELY 26 FEET

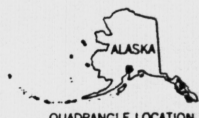

TYONEK (B-1), ALASKA
N6115-W15000/15X22.5

1958
MINOR REVISIONS 1964

FOR SALE BY U.S. GEOLOGICAL SURVEY
FAIRBANKS, ALASKA, DENVER 25, COLORADO OR WASHINGTON 25, D.C.
A FOLDER DESCRIBING TOPOGRAPHIC MAPS AND SYMBOLS IS AVAILABLE ON REQUEST