

UNITED STATES
DEPARTMENT OF THE INTERIOR
GEOLOGICAL SURVEY

CORDOVA (C-3) QUADRANGLE
ALASKA
1:63 360 SERIES (TOPOGRAPHIC)

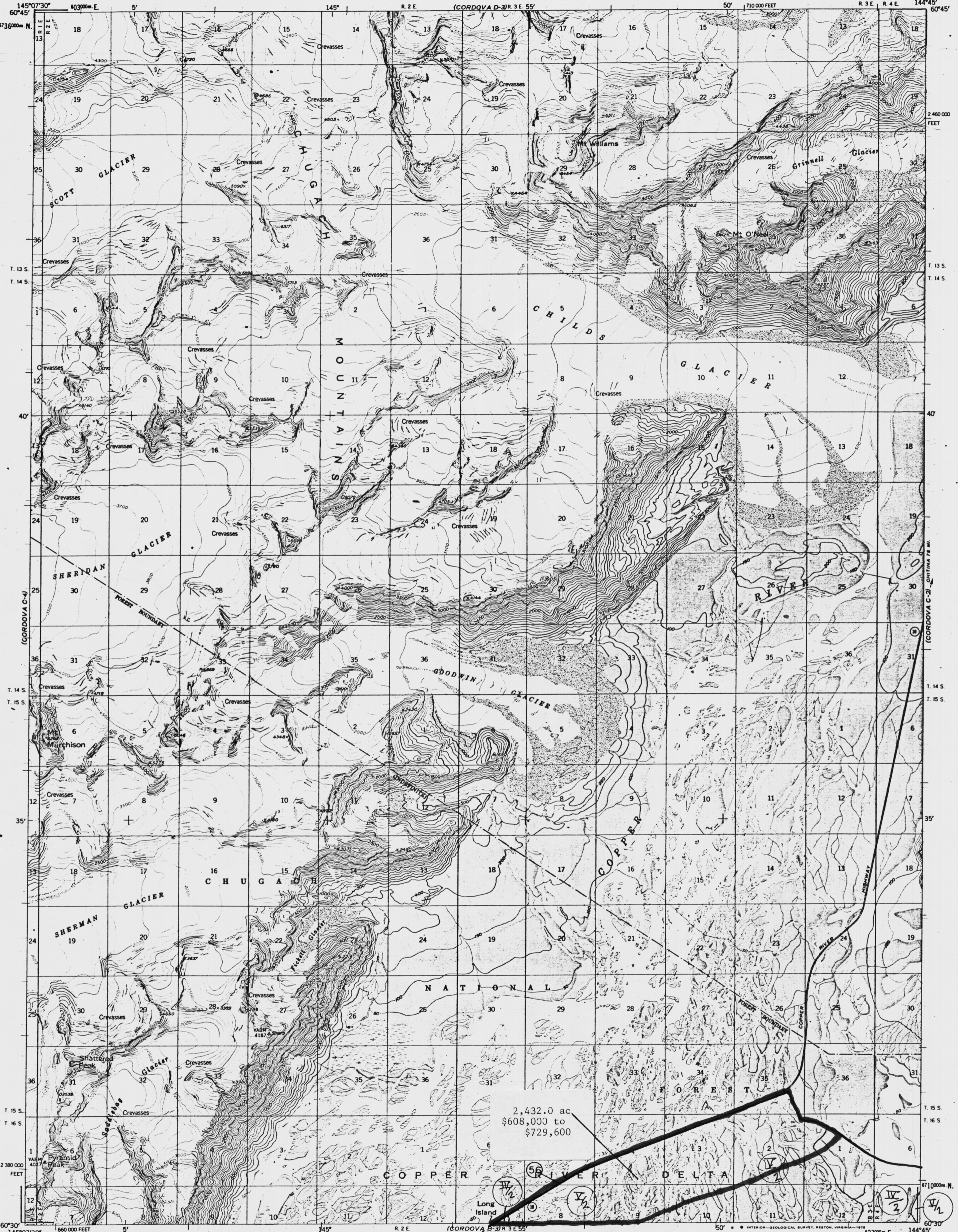

2,432.0 ac
\$608,000 to
\$729,600

Mapped, edited, and published by the Geological Survey
Control by USGS and USFS
LEGISLATIVE DESIGNATED AREA
Topography by photogrammetric methods from aerial photographs
taken 1950-1951
(56) COPPER RIVER DELTA CRITICAL HABITAT AREA AS 16.20-230
Universal Transverse Mercator projection, 1927 North American datum
10,000-foot grid based on Alaska coordinate system, zone 3
1000-meter Universal Transverse Mercator grid ticks,
zone 6, shown in blue
Land lines represent unsurveyed and unmarked locations
predetermined by the Bureau of Land Management
Folio CR-6, Copper River Meridian
Swamps, as portrayed, indicate only the wetter areas.

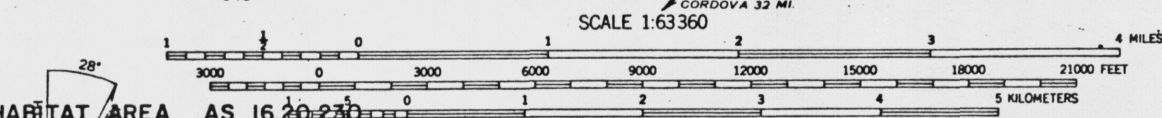

CONTOUR INTERVAL 100 FEET
DOTTED LINES REPRESENT 50-FOOT CONTOURS
NATIONAL GEODETIC VERTICAL DATUM OF 1929



CORDOVA (C-3) 1975
Light-duty
State Route

FOR SALE BY U.S. GEOLOGICAL SURVEY
FAIRBANKS, ALASKA 99701, DENVER, COLORADO 80225, OR RESTON, VIRGINIA 22092

Plafker (1967)

CORDOVA (C-3), ALASKA
N6030-W14445/15333
1951
Division of Techni