

UNITED STATES
DEPARTMENT OF THE INTERIOR
GEOLOGICAL SURVEY

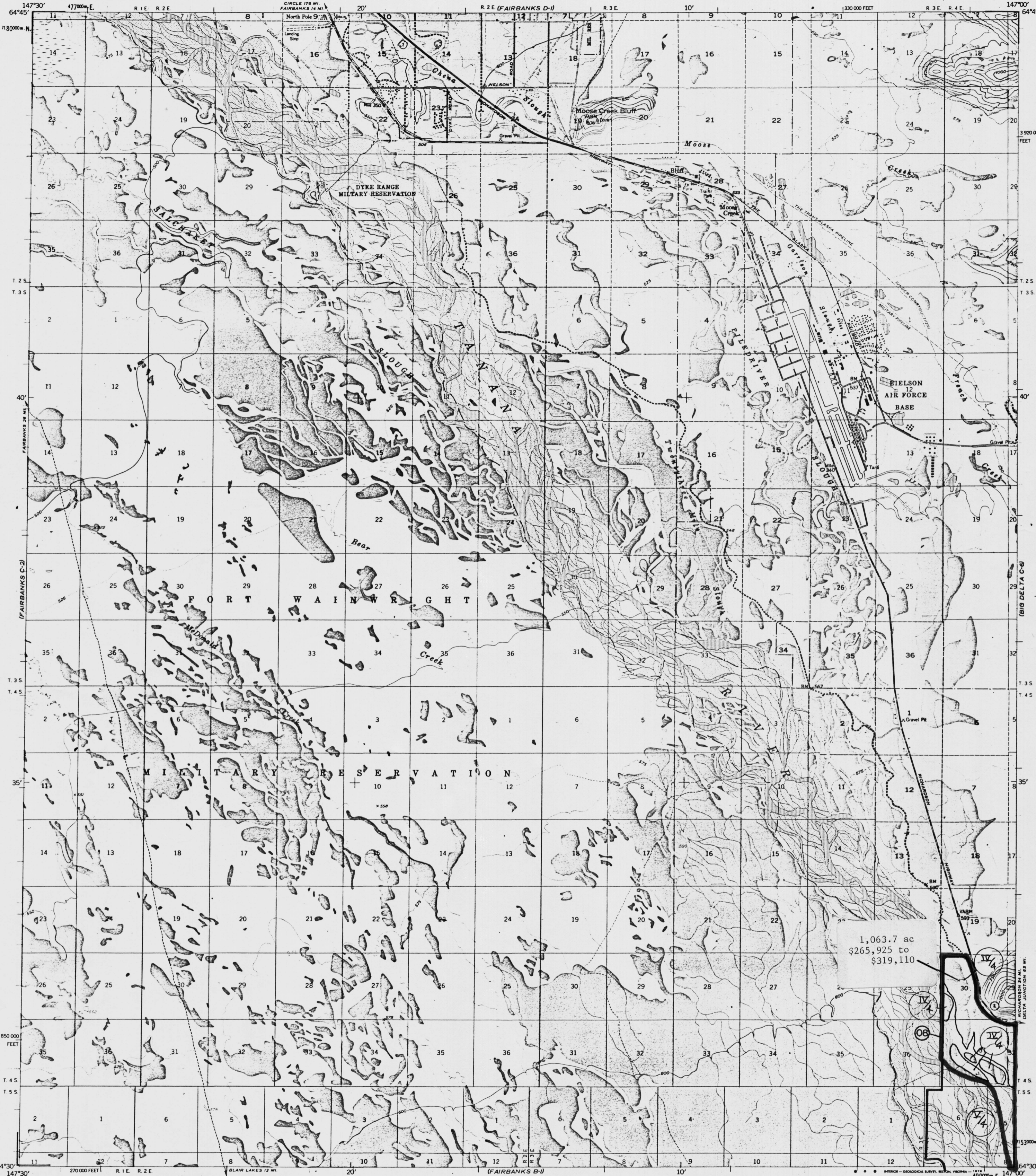

1,063.7 ac
\$265,925 to
\$319,110

Maped, edited, and published by the Geological Survey
Control by USGS and USC&GS

Topography by photogrammetric methods from aerial photographs
taken 1949. **LEGISLATIVE DESIGNATED AREA**
Universal Transverse Mercator projection, 1927 North American datum
10,000-foot base on Alaska grid plane system, zone 2
1000-meter Universal Transverse Mercator grid ticks,
zone 6, shown in blue

Land lines printed in gray represent unsurveyed and
unmarked locations predetermined by the Bureau of
Land Management, Folio F-9, Fairbanks Meridian

Swamps, as portrayed, indicate only the wetter areas,
usually of low relief, as interpreted from aerial photographs
Revised shown in purple compiled from aerial photographs

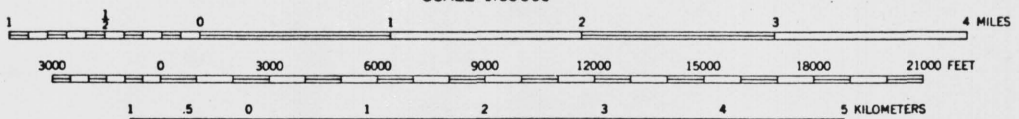
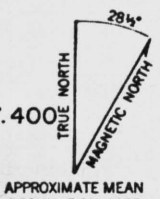

CONTOUR INTERVAL 50 FEET
DOTTED LINES REPRESENT 25-FOOT CONTOURS
DATUM IS MEAN SEA LEVEL



ROAD CLASSIFICATION
FAIRBANKS (C1), 1975
Medium-duty
Unimproved dirt

FAIRBANKS (C-1), ALASKA
N6430-W14700/15X30

1950
PHOTOREVISED 1972 AND 1975

FOR SALE BY U.S. GEOLOGICAL SURVEY
FAIRBANKS, ALASKA 99701, DENVER, COLORADO 80225, OR RESTON, VIRGINIA 22092
A FOLDER DESCRIBING TOPOGRAPHIC MAPS AND SYMBOLS IS AVAILABLE ON REQUEST