

(KENAI A-4)

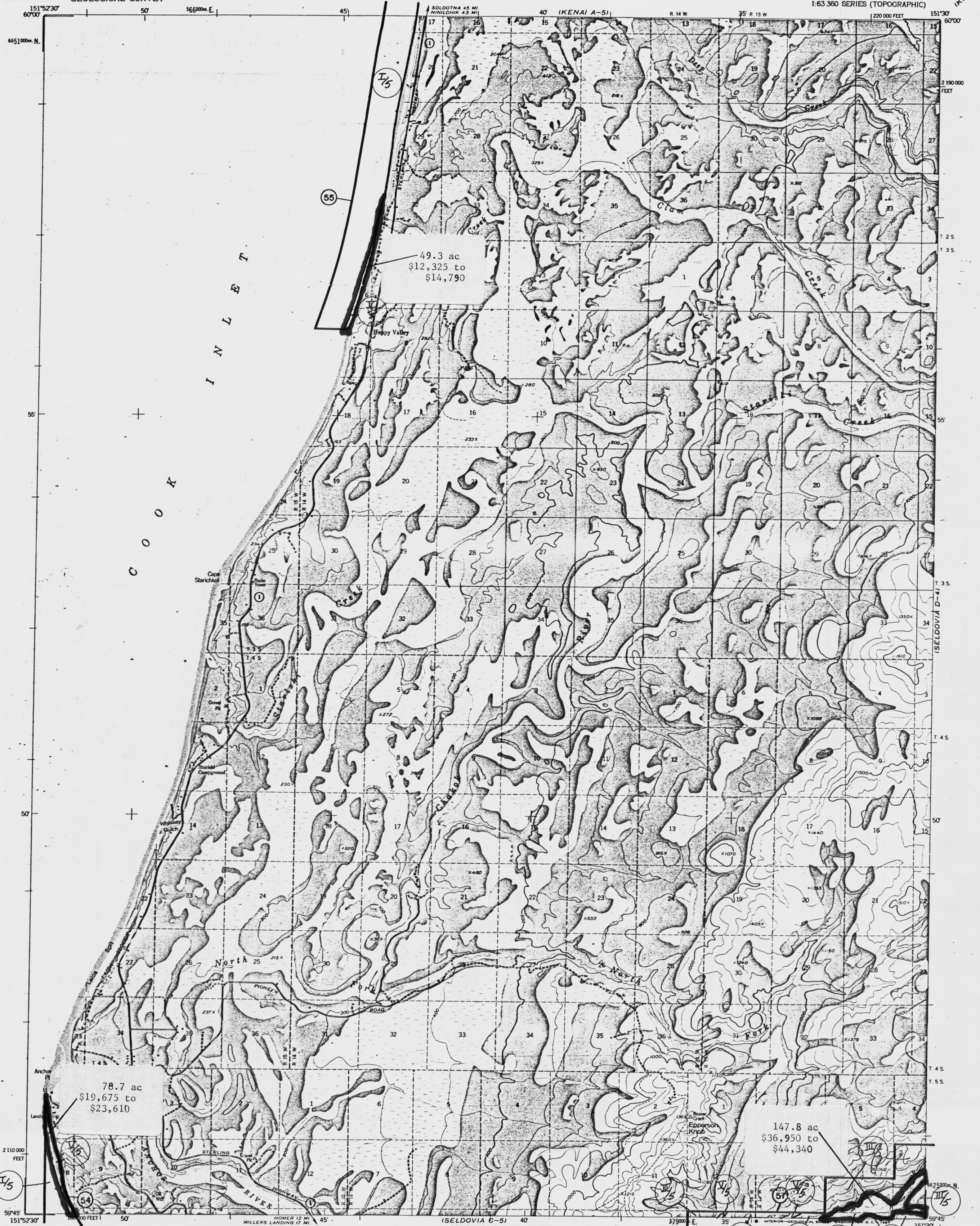

Mapped, edited, and published by the Geological Survey
Control by USCE

Topography by photogrammetric methods from aerial photographs taken 1953-54
LEGISLATIVE DESIGNATED AREA

Selected hydrographic data compiled from USC&GS Charts 8531 (1:62,500) KACHEMAK BAY CRITICAL HABITAT AREA AS 16.20.230 and 8532 (1:62,500) ANCHOR RIVER & FRITZ CREEK CRITICAL HABITAT AREA AS 16.20.230. This information is not intended for navigational purposes.

Universal Transverse Mercator projection, zone 4, 10,000-foot grid based on Alaska coordinate system, zone 4. 1000-meter Universal Transverse Mercator grid ticks, zone 5, shown.

Gray land lines represent unsurveyed and unmarked locations predetermined by the Bureau of Land Management. Folio S-16, Seward Meridian.

Swamps, as portrayed, indicate only the wetter areas, usually of low relief, as interpreted from aerial photographs.

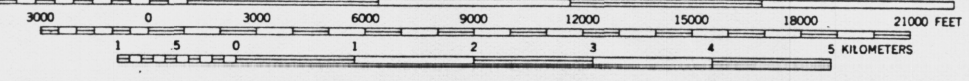
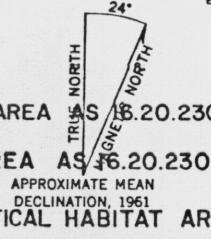

CONTOUR INTERVAL 100 FEET
DATUM IS MEAN SEA LEVEL
DEPTH CURVES IN FEET-DATUM IS MEAN LOWER LOW WATER
SHORELINE SHOWN REPRESENTS THE APPROXIMATE LINE OF MEAN HIGH WATER
THE MEAN RANGE OF TIDE IS APPROXIMATELY 17 FEET



ROAD CLASSIFICATION
Unimproved
Light-duty
Medium-duty
State Route

FOR SALE BY U.S. GEOLOGICAL SURVEY
FAIRBANKS, ALASKA 99701, DENVER, COLORADO 80225, OR WASHINGTON, D.C. 20242
A FOLDER DESCRIBING TOPOGRAPHIC MAPS AND SYMBOLS IS AVAILABLE ON REQUEST

SELDOVIA (D-5), ALASKA
N5945-W15130/15X22.5

1961
MINOR REVISIONS 1966