

UNITED STATES
DEPARTMENT OF THE INTERIOR
GEOLOGICAL SURVEY

SEWARD (D-7) QUADRANGLE
ALASKA
1:63 360 SERIES (TOPOGRAPHIC)

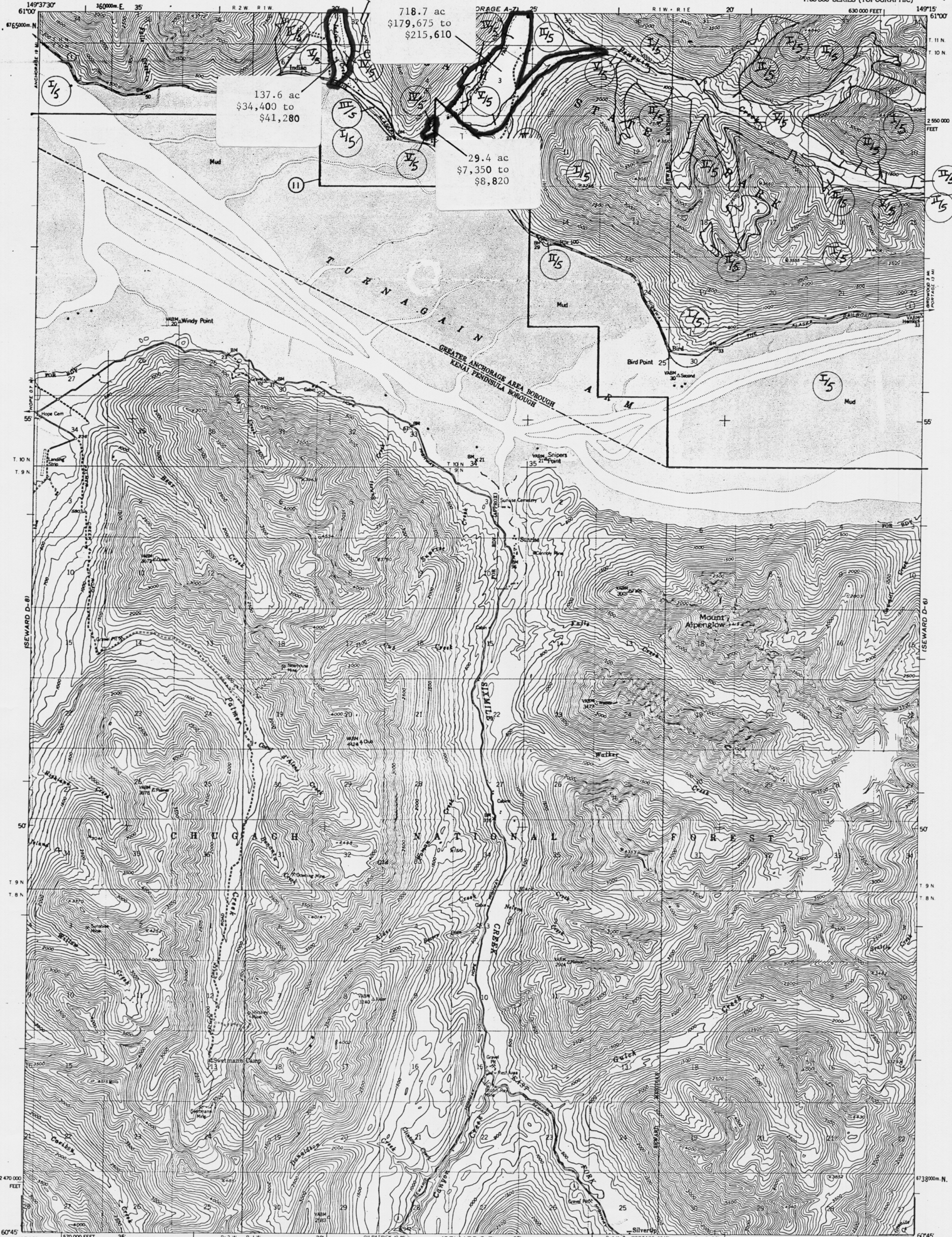

137.6 ac
\$34,400 to
\$41,280

718.7 ac
\$179,675 to
\$215,610

29.4 ac
\$7,350 to
\$8,820

Mapped, edited, and published by the Geological Survey
Control by USC&GS and USACE
LEGISLATIVE DESIGNATED AREA
Topography by photogrammetric methods from aerial photographs taken 1950
CHUGACH NATIONAL FOREST AS 41.21.121-125
Mud flat areas compiled from photographic information. Offshore rocks compiled from USC&GS Chart 8553 (1:194,154 scale, 1952). This information is not intended for navigational purposes.
Universal Transverse Mercator projection, 1927 North American datum 10,000-foot grid based on Alaska coordinate system, zone 4 1000-metre Universal Transverse Mercator grid ticks, zone 6, shown in blue
Land lines represent unsurveyed and unmarked locations predetermined by the Bureau of Land Management

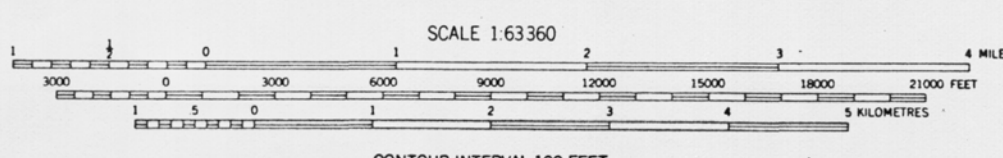

ROAD CLASSIFICATION SEWARD (D-7) 1974

Medium-duty	Light-duty
Unimproved dirt	State Route



SEWARD (D-7), ALASKA
N6045-W14915/15X22.5
1951