

UNITED STATES  
DEPARTMENT OF THE INTERIOR  
GEOLOGICAL SURVEY

SKAGWAY (B-2), QUADRANGLE  
ALASKA  
1:63 360 SERIES (TOPOGRAPHIC)

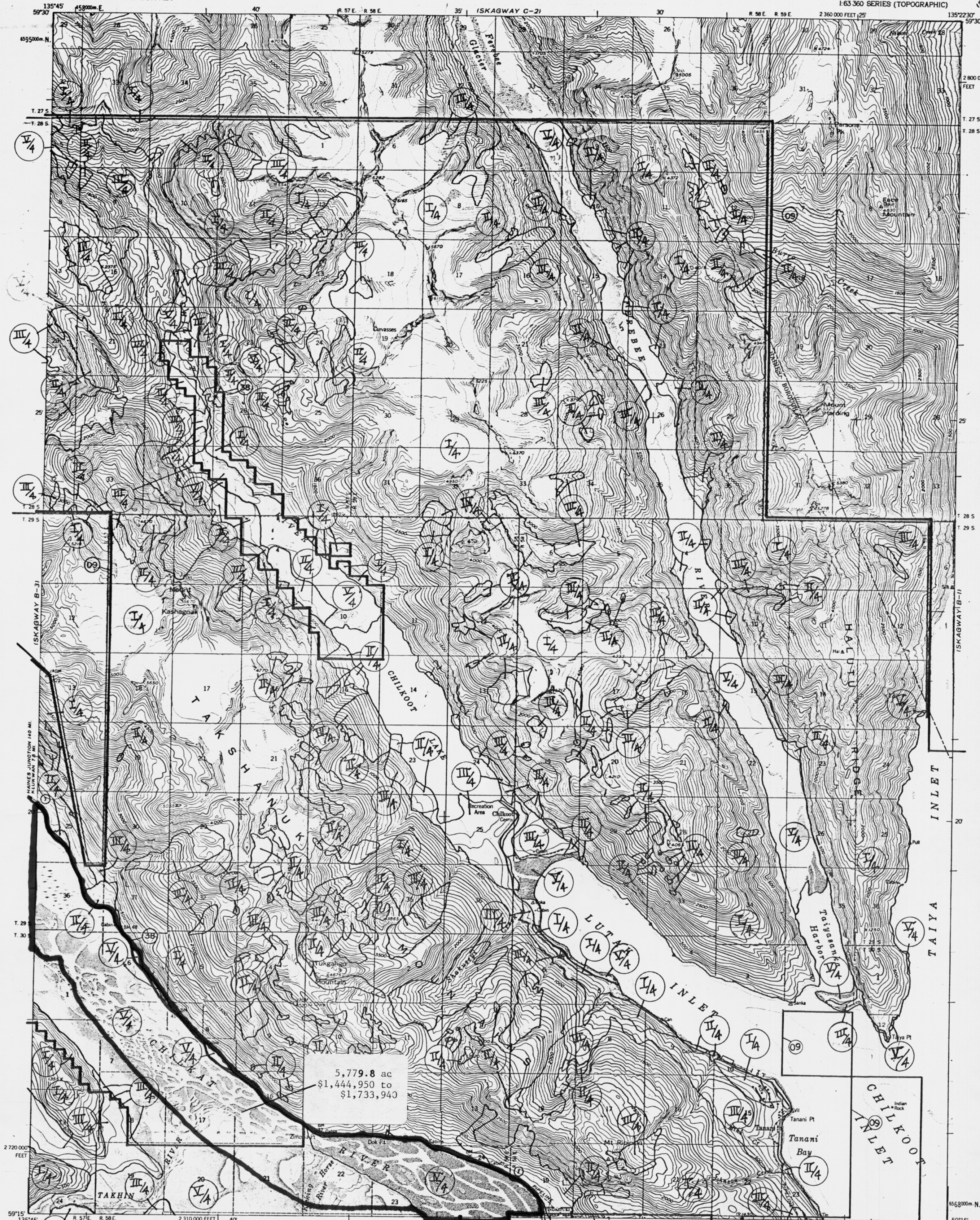

5,779.8 ac  
\$1,444,950 to  
\$1,733,940

Map published, and published by the Geological Survey  
Control by U.S. Geological Survey and Geodetic Survey of Canada  
Topography by photogrammetric methods from aerial photographs  
taken 1948 and annotated 1954. Map not field checked  
Selected hydrographic data compiled from USCGS  
Chart 8303 (1958). This information is not intended  
for navigation.  
Universal Transverse Mercator projection, 1927 North American datum  
10,000-foot grid based on Alaska coordinate system, zone 1  
1000 meter Universal Transverse Mercator grid ticks,  
zone 8, shown in blue  
Gray lines represent unsurveyed and unmarked locations  
predetermined by the State of Alaska, Division of Lands  
Folio CR-11, Copper River Meridian  
APPROXIMATE MEAN  
DECLINATION, 1954  
SCALE 1:63360  
CONTOUR INTERVAL 100 FEET  
NATIONAL GEODETIC VERTICAL DATUM OF 1929  
DEPTH CURVES IN FEET - DATUM IS MEAN LOWER LOW WATER  
SHORELINE SHOWN REPRESENTS THE APPROXIMATE LINE OF MEAN HIGH WATER  
THE MEAN RANGE OF TIDE IS APPROXIMATELY 14 FEET  
FOR SALE BY U.S. GEOLOGICAL SURVEY  
FAIRBANKS, ALASKA 99701, DENVER, COLORADO 80225, OR RESTON, VIRGINIA 22092  
A FOLDER DESCRIBING TOPOGRAPHIC MAPS AND SYMBOLS IS AVAILABLE ON REQUEST  
ROAD CLASSIFICATION  
SKAGWAY (B2) 1977  
Medium-duty  
Unimproved dirt  
State Route  
QUADRANGLE LOCATION  
SKAGWAY (B-2), ALASKA  
N9915-W13522.5/15X22.5  
1954