

LATITUDE 63° 54' 38" N.  
LONGITUDE 148° 37' 23" W.

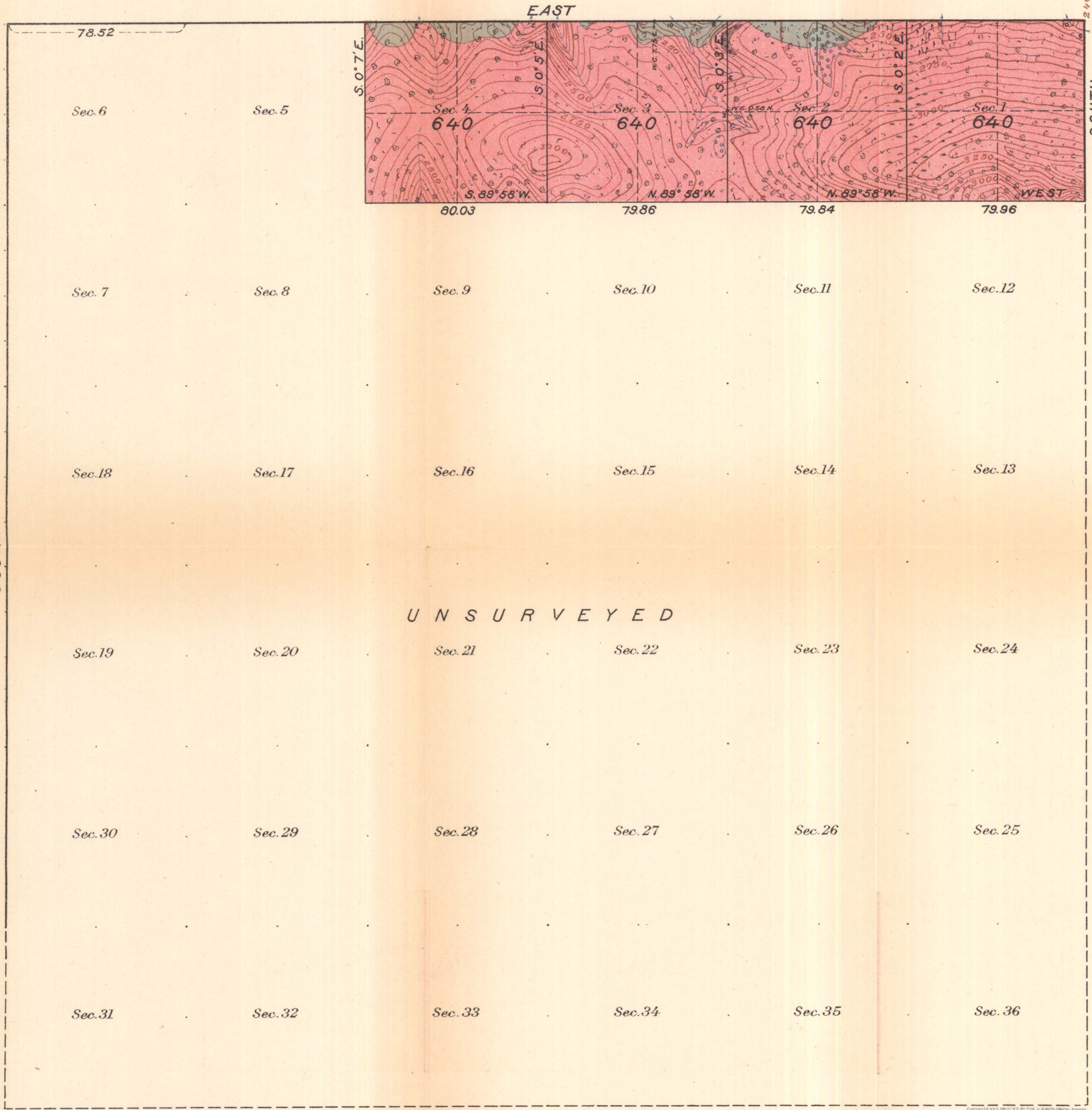
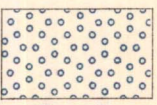
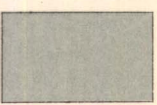
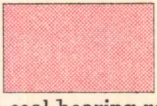
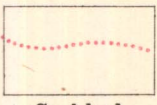

EXPLANATION

-  Gravels  
(Partly underlain by coal)
-  Coal-bearing rocks
-  Non coal-bearing rocks  
(Igneous rocks and schists)
-  Coal bed  
(Smut or position inferred)

Topography by General Land Office. Surveyed in 1915  
Geology by G. C. Martin, A. G. Maddren, and R. M. Overbeck. Surveyed in 1916

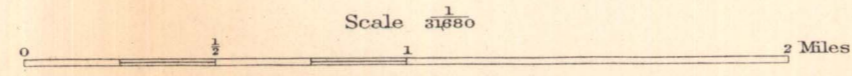

Contour interval 50 feet  
Datum mean lower low water in Knik Arm  
Elevations from levels on preliminary line of railroad by Alaskan Engineering Commission  
extended by vertical-angle control

TOWNSHIP PLAT AND COAL MAP OF T. 12 S., R. 6 W., FAIRBANKS BASE AND MERIDIAN  
NENANA COAL FIELD, ALASKA