

NUMBERS INDICATE IDENTIFICATION POINTS ON MAP BELOW

PROFILES NOT ADJUSTED TO COMMON DATUM

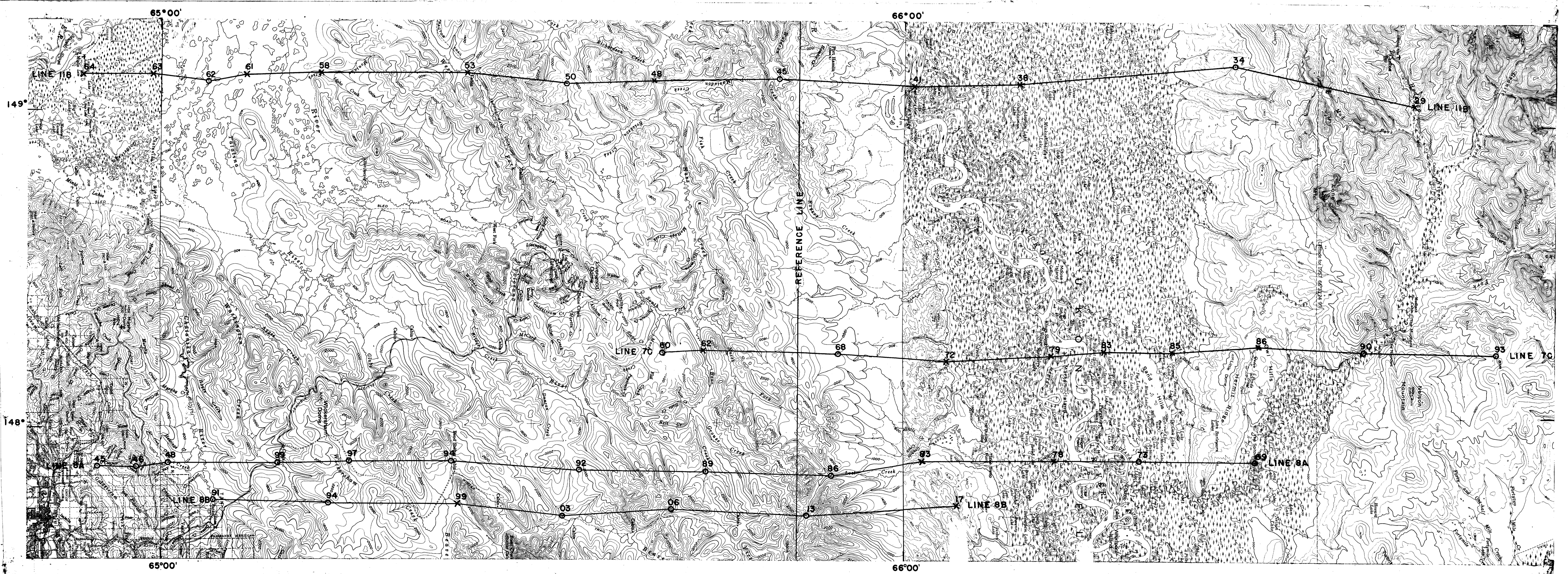

BASE MAP BY TOPOGRAPHIC DIVISION
U. S. GEOLOGICAL SURVEY

SURVEY BY G. E. ANDREASEN, AT A BAROMETRIC ELEVATION OF 2500 FEET, 1958

TOTAL INTENSITY AEROMAGNETIC PROFILES OF THE YUKON FLATS-KANDIK AREA, ALASKA

FIGURE 1 OF 7
FLIGHTS 8A, 8B, 7C, AND 11

→ NORTH

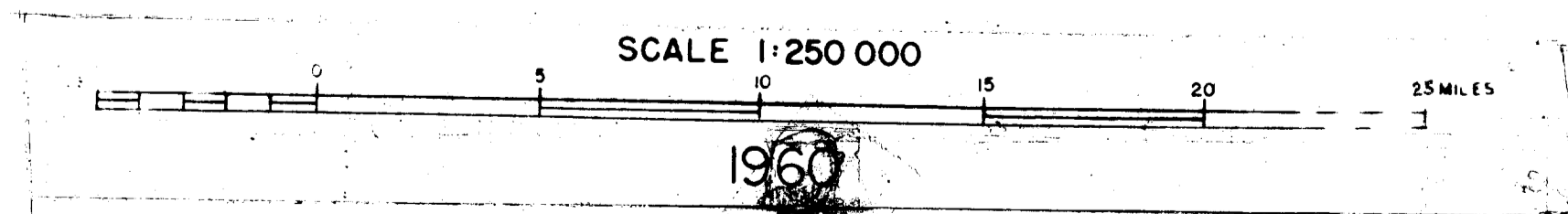

This map is preliminary and has not been edited or revised for conformity to Geological Survey standards and nomenclature.

