

EXPLANATION OF SYMBOLS

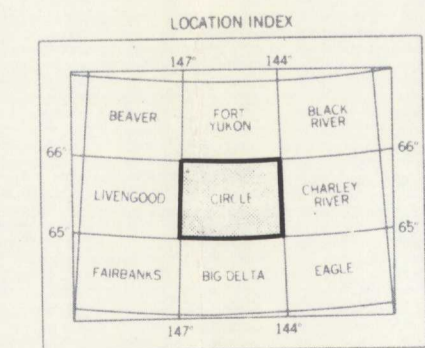
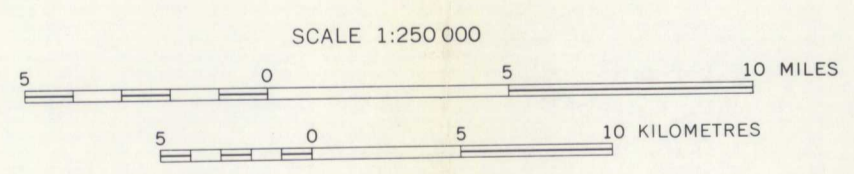
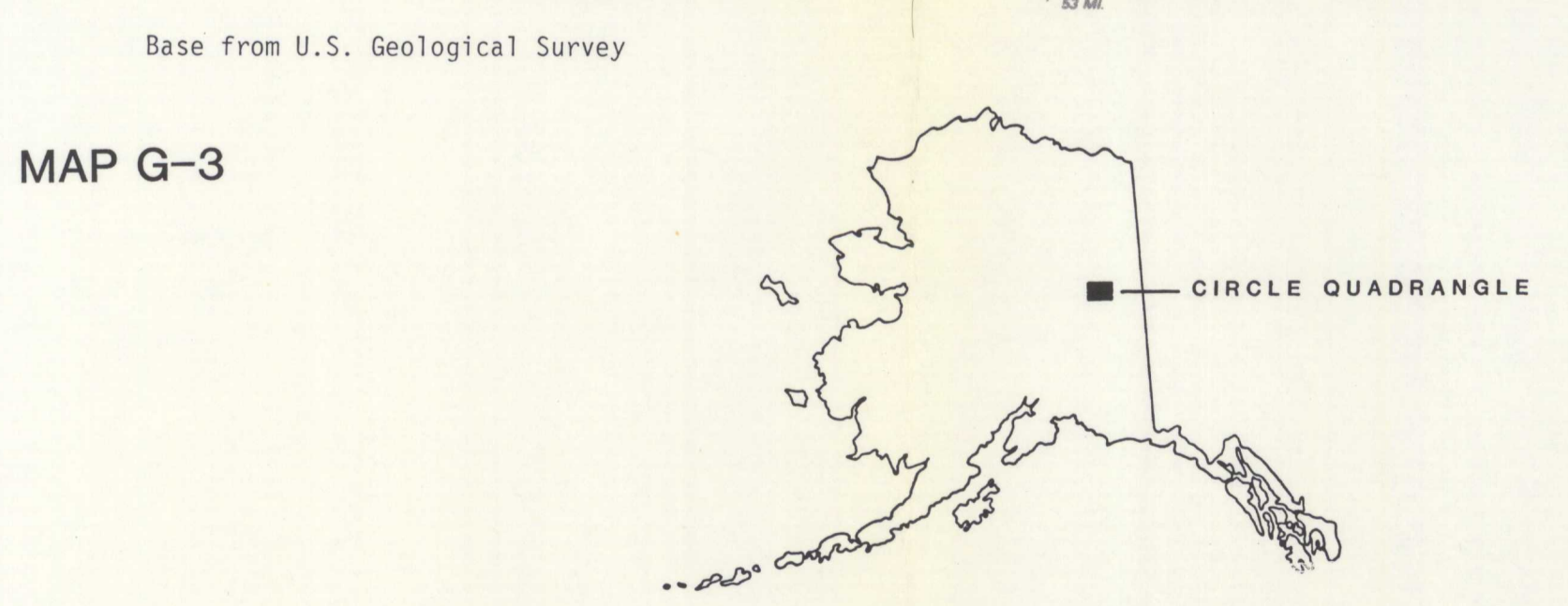
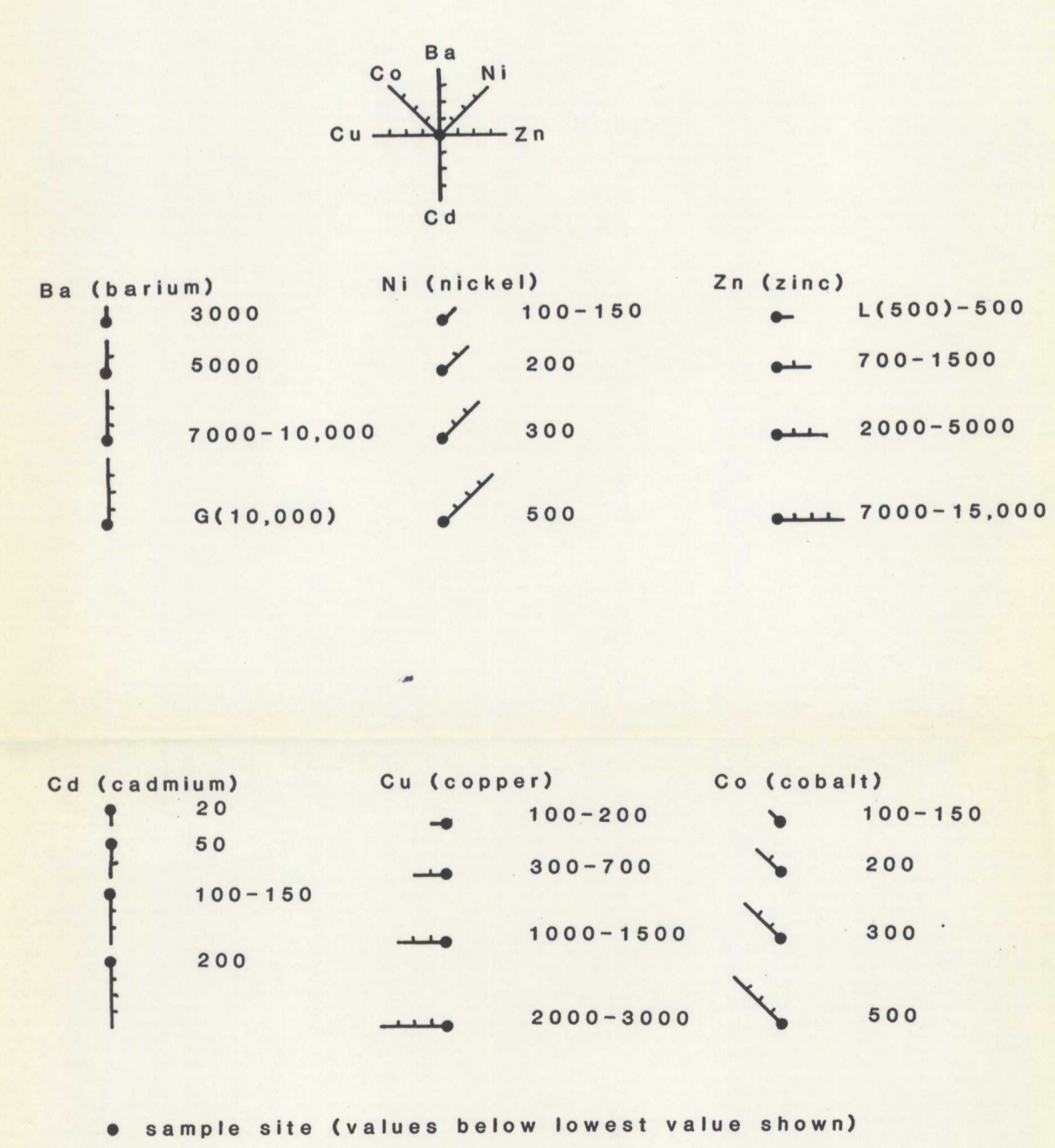

Geology from Foster and others, 1983, U.S. Geological Survey Open-File Report 83-170-A

- All values in parts per million (ppm).
- L=detected, but below limit of determination.
- G=greater than value shown.

This map is preliminary and has not been edited or reviewed for conformity with U.S. Geological Survey editorial standards and stratigraphic nomenclature

GEOCHEMICAL MAP SHOWING DISTRIBUTION OF BARIUM, NICKEL, ZINC, CADMIUM, COPPER, AND COBALT IN THE NONMAGNETIC HEAVY-MINERAL FRACTION OF STREAM SEDIMENT, CIRCLE QUADRANGLE, ALASKA

By
Richard B. Tripp, William D. Crim, James D. Hoffman, Richard M. O'Leary, and Donald A. Risoli
1986